



Pop-Link Mounting Systems



US Pat. No. 9353906

The Pop-Link® mounting system offers secure and effective solutions for mounting and positioning switches, sensors, vision cameras, light sources, lasers and more. The PL, HDPL and JRPL Series offer great versatility with various components that "pop" together, with less bolts to secure. Cost effective and manufactured to the same high standards of all the other ergonomic and positioning support systems produced by AD&D, the Pop-Link® mounting system is an extremely versatile, quality mounting solution. Pop-Link® mounting systems... the possibilities are endless!

**BASES - POSTS - ADAPTERS - HYPERLINKS - SENSOR BRACKETS
KNUCKLES - CAMERA BRACKETS - LIGHT BRACKETS**

PL-SERIES

The "original" PL-Series provides low-cost, effective solutions for mounting switches, sensors, vision cameras, lighting sources, lasers and virtually any peripheral devices that needs to be frequently re-positioned, or exact position is not known at set up. All products in the PL-Series are made from anodized 6061 aluminum with stainless steel fasteners. The PL-Series is compatible with most Pop-Link bracket products. The PL-series can hold weights up to 31kg (~70 lbs) out from centreline of ball.

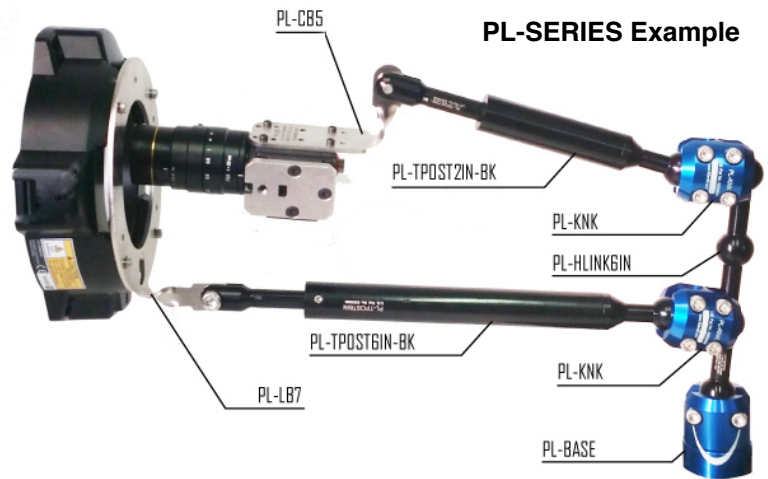

HDPL-SERIES

The HDPL-Series provides all of the versatility as the PL-Series, but can handle a heavier load. All products in the HDPL-Series are also made from anodized 6061 aluminum with stainless steel fasteners. The HDPL-Series is compatible with most Pop-Link bracket products. The PHDL-series can hold weights up to 72kg (~160 lbs) out from centreline of ball.

HDPL-SERIES Example

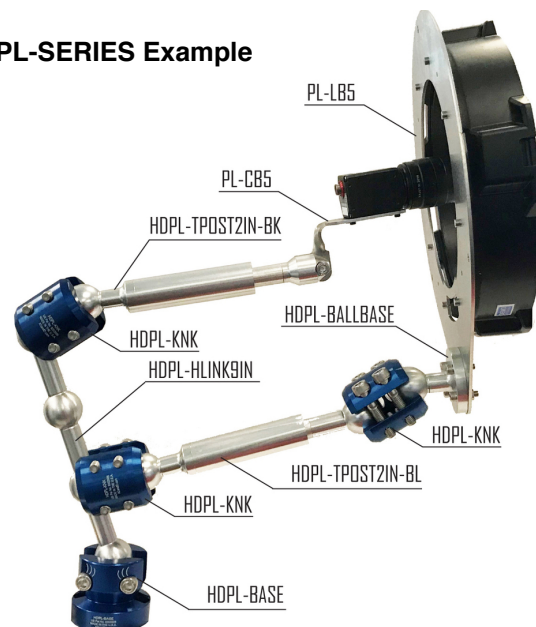

JRPL-SERIES

The newest addition to the Pop-Link® family, the JRPL Series has been designed for light weight applications such as proximity sensors. All products in the JRPL Series are made from anodized 6061 aluminum with stainless steel fasteners. The JRPL Series is compatible with Sensor Brackets listed in the Bracket Series. The JRPL-series can hold weights up to 2.2kg (~5 lbs) out from centreline of ball.

For more information please contact:



BOCK OPTRONICS INC.

14 Steinway Blvd., Unit 7
Toronto, Ontario M9W 6M6

Tel: (416) 674-2804
sales@bockoptronics.ca
www.bockoptronics.ca

PL-SERIES SYSTEM COMPONENTS

PL-SERIES ESSENTIAL COMPONENTS

P/N **PL-BASE**

Base

The foundation of the Pop-Link™ System. It all starts here! Easily mounts to most aluminum extrusion.

PL-BASE attaches to external thread. Internal thread is tapped for English or metric mounting to extrusion. Not intended to be used with Camera or Light Brackets, only with Sensor Brackets.



P/N **PL-HDPL-DSTAND1**

Demo / Lab Stand Platform

A stainless steel stand to which you can mount a base from The PL Series (PL-BASE) and The HDPL Series (HDPL-BASE).

Ships with mounting hardware for both bases (bases not included).



P/N **PL-KNK**

Knuckle

Adaptable to the ball ends of all Posts and Hyperlinks to achieve maximum articulation. A strategic player in the Pop-Link system.



P/N **PL-BALLBASE**

Ball Base

The ball end of the PL-BALLBASE allows direct mounting to a PL-KNK or a PL-BASE. The flat side allows mounting to your products, such as HMIs or panels.



PL-SERIES ADAPTERS

P/N **PL-PBALL**

Power Ball

May be attached to any Post for adaptation to another Base or a Knuckle.



P/N **PL-14-20THADAPT**

1/4-20 Thread Adapter

Threads to the end of any Post to obtain a 1/4-20 thread commonly used in the vision industry.



P/N **PL-EXTADPT**

Extrusion Adapter

Mount Pop-Link product to most common aluminum extrusions sizes.



P/N **PL-90BALLADPT**

90° Ball Adapter

For branching out to a second location, while maintaining one Base.



P/N **PL-BKADPT**

Bracket Adapter

May be used to mount any bracket in the "Bracket Series" to an M10x1.5 male thread, of Threaded Post.



PL-SERIES HYPERLINKS

P/N **PL-HLINK2IN**

2" Hyperlink

A 2" ridged coupler extension, that can be mounted to (2) Bases and/or Knuckles.

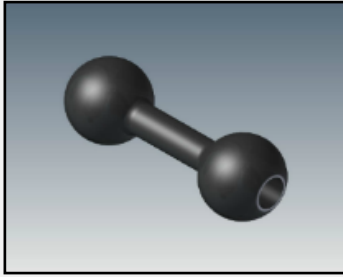

P/N **PL-HLINK12IN**

12" Hyperlink

A 12" ridged coupler extension, that can be mounted to (7) Bases and/or Knuckles.

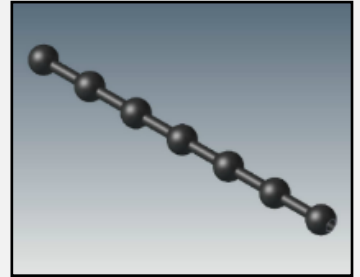

P/N **PL-HLINK4IN**

4" Hyperlink

A 4" ridged coupler extension, that can be mounted to (3) Bases and/or Knuckles.

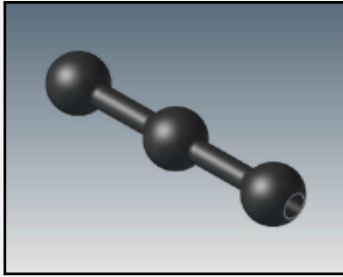

P/N **PL-HLINK14IN**

14" Hyperlink

A 14" ridged coupler extension, that can be mounted to (8) Bases and/or Knuckles.

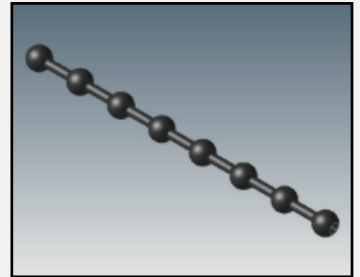

P/N **PL-HLINK6IN**

6" Hyperlink

A 6" ridged coupler extension, that can be mounted to (4) Bases and/or Knuckles.

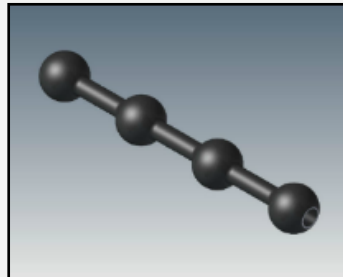

P/N **PL-HLINK8IN**

8" Hyperlink

A 8" ridged coupler extension, that can be mounted to (5) Bases and/or Knuckles.

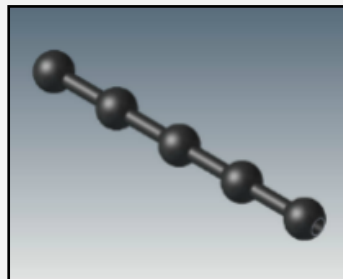

P/N **PL-HLINK10IN**

10" Hyperlink

A 10" ridged coupler extension, that can be mounted to (6) Bases and/or Knuckles.

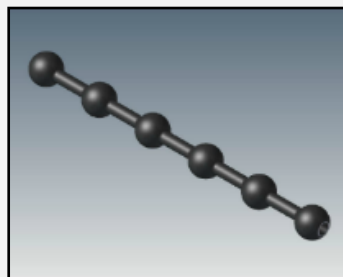

PL-SERIES POSTS

P/N PL-SPOST-BK

Standard Post - Bracket Adaptable End

A rigid (non-telescopic) mount post with an adapter on one end to mount to most bracket products.



P/N PL-SPOST-THD

Standard Post - Threaded End

A rigid (non-telescopic) mount post with an M10x1.5 male threaded end.



P/N PL-SPOSTEXT5IN-BK

Standard Post - 5" - Bracket Adaptable End

A rigid (non-telescopic) mount post with an adapter on one end to mount to most bracket products.
5" (127mm) length.



P/N PL-SPOSTEXT5IN-THD

Standard Post - 5" - Bracket Adaptable End

A rigid (non-telescopic) mount post with an M10x1.5 male threaded end.
5" (127mm) length.



P/N PL-SPOSTEXT5IN-BK

Standard Post - 7" - Bracket Adaptable End

A rigid (non-telescopic) mount post with an adapter on one end to mount to most bracket products.
7" (178mm) length.



P/N PL-SPOSTEXT7IN-THD

Standard Post - 7" - Bracket Adaptable End

A rigid (non-telescopic) mount post with an M10x1.5 male threaded end.
7" (178mm) length.



P/N PL-TPOST2IN-BK

2" Telescopic Post - Bracket Adaptable End

Telescopic post that may be positioned within a 2" (51mm) range of travel, with an adapter on one end to mount to most bracket products.



P/N PL-TPOST2IN-BL

2" Telescopic Post - Ball End

Telescopic post that may be positioned within a 2" (51mm) range of travel, with a ball end.



P/N PL-TPOST2IN-THD

2" Telescopic Post - Threaded End

Telescopic post that may be positioned within a 2" (51mm) range of travel, with an M10x1.5 male threaded end.



P/N PL-TPOST6IN-BK

6" Telescopic Post - Bracket Adaptable End

Telescopic post that may be positioned within a 6" (152mm) range of travel, with an adapter on one end to mount to most bracket products.



P/N PL-TPOST6IN-BL

6" Telescopic Post - Ball End

Telescopic post that may be positioned within a 6" (152mm) range of travel, with a ball end.



P/N PL-TPOST6IN-THD

6" Telescopic Post - Threaded End

Telescopic post that may be positioned within a 6" (152mm) range of travel, with an M10x1.5 male threaded end.



HDPL-SERIES SYSTEM COMPONENTS

HDPL-SERIES ESSENTIAL COMPONENTS

P/N HDPL-BASE

Base

The foundation of the Pop-Link™ System. It all starts here! Easily mounts to most aluminum extrusion.

HDPL-BASE attaches to external thread. Internal thread is tapped for English or metric mounting to extrusion. Not intended to be used with Camera or Light Brackets, only with Sensor Brackets.



included).

P/N HDPL-KNK

Knuckle

Adaptable to the ball ends of all Posts and Hyperlinks to achieve maximum articulation. A strategic player in the Pop-Link system.



P/N PL-HDPL-DSTAND1

Demo / Lab Stand Platform

A stainless steel stand to which you can mount a base from the PL-Series (PL-BASE) and the HDPL-Series (HDPL-BASE). Ships with mounting hardware for both bases (bases not



P/N HDPL-BALLBASE

Ball Base

The ball end of the HDPL-BALLBASE allows direct mounting to a PL-KNK or a PL-BASE. The flat side allows mounting to your products, such as HMIs or panels.



HDPL-SERIES HYPERLINKS

P/N HDPL-HLINK3IN

3" Hyperlink

A 3" ridged coupler extension, that can be mounted to (2) Bases and/or Knuckles.



P/N HDPL-HLINK9IN

9" Hyperlink

A 9" ridged coupler extension, that can be mounted to (4) Bases and/or Knuckles.



P/N HDPL-HLINK6IN

6" Hyperlink

A 6" ridged coupler extension, that can be mounted to (3) Bases and/or Knuckles.



P/N HDPL-HLINK12IN

12" Hyperlink

A 12" ridged coupler extension, that can be mounted to (5) Bases and/or Knuckles.



HDPL-SERIES POSTS

P/N HDPL-SPOST-BK

Standard Post - Bracket Adaptable End

A rigid (non-telescopic) mount post with an adapter on one end to mount to most bracket products.



P/N HDPL-SPOST-THD

Standard Post - Threaded End

A rigid (non-telescopic) mount post with an M16x2 male threaded end.



P/N HDPL-TPOST2IN-BK

2" Telescopic Post - Bracket Adaptable End

Telescopic post that may be positioned within a 2" (51mm) range of travel, with an adapter on one end to mount to most bracket products.



P/N HDPL-TPOST2IN-BL

2" Telescopic Post - Ball End

Telescopic post that may be positioned within a 2" (51mm) range of travel, with a ball end.



P/N HDPL-TPOST2IN-THD

2" Telescopic Post - Threaded End

Telescopic post that may be positioned within a 2" (51mm) range of travel, with an M16x2 male threaded end.



P/N HDPL-TPOST6IN-BK

6" Telescopic Post - Bracket Adaptable End

Telescopic post that may be positioned within a 6" (152mm) range of travel, with an adapter on one end to mount to most bracket products.



P/N HDPL-TPOST6IN-BL

6" Telescopic Post - Ball End

Telescopic post that may be positioned within a 6" (152mm) range of travel, with a ball end.



P/N HDPL-TPOST6IN-THD

6" Telescopic Post - Threaded End

Telescopic post that may be positioned within a 6" (152mm) range of travel, with an M16x2 male threaded end.



P/N HDPL-TPOST8IN-BK

8" Telescopic Post - Bracket Adaptable End

Telescopic post that may be positioned within a 8" (203mm) range of travel, with an adapter on one end to mount to most bracket products.



P/N HDPL-TPOST8IN-BL

8" Telescopic Post - Ball End

Telescopic post that may be positioned within a 8" (203mm) range of travel, with a ball end.



P/N HDPL-TPOST8IN-THD

8" Telescopic Post - Threaded End

Telescopic post that may be positioned within a 8" (203mm) range of travel, with an M16x2 male threaded end.



JRPL-SERIES SYSTEM COMPONENTS

JRPL-SERIES ESSENTIAL COMPONENTS

P/N JRPL-BASE

Base

The foundation of the Pop-Link™ System. It all starts here! Easily mounts to most aluminum extrusion.



P/N JRPL-BALLBASE

Knuckle

Adaptable to the ball end of Post and Hyperlinks to achieve maximum articulation. A strategic player in the Pop-Link™ system.



JRPL-SERIES POST AND HYPERLINKS

P/N JRPL-SPOST-BK

Standard Post - Bracket Adaptable End

A rigid (non-telescopic) mount post with an adapter on one end to mount most products in the Bracket Series.



P/N JRPL-HLINK3IN

3" Hyperlink

A 3" ridged coupler extension, that can be mounted to (2) Bases and/or Knuckles.



P/N JRPL-HLINK1IN

1" Hyperlink

A 1" ridged coupler extension, that can be mounted to (2) Bases and/or Knuckles.



P/N JRPL-HLINK4IN

4" Hyperlink

A 4" ridged coupler extension, that can be mounted to (2) Bases and/or Knuckles.



P/N JRPL-HLINK2IN

2" Hyperlink

A 2" ridged coupler extension, that can be mounted to (2) Bases and/or Knuckles.



BRACKET SERIES SYSTEM COMPONENTS

CAMERA BRACKETS

P/N PL-CB1

For use with:

- Cognex 5000 Series
- Cognex DM500 Series



P/N PL-CB2

For use with:

- Cognex 7000 Series
- Keyence IV Vision Sensor
- Keyence SR-D100
- Keyence SR-500
- Keyence SR-750



P/N PL-CB3

For use with:

- Cognex 4G Checker
- Cognex DM50
- Cognex DM60
- Cognex DM200
- Cognex DM300
- Cognex Micro1000



P/N PL-CB4

For use with:

- Banner Presence Plus4
- Keyence CA-CM20
- Keyence CV-200C
- Keyence CV-500 Camera
- Keyence XG-035C
- Keyence XG200C
- Keyence XG-H500
- Keyence XG-HL02/04/08
- Keyence XG-HL2100
- Keyence SR-6000



P/N PL-CB5

For use with:

- Cognex 8000 Series
- Keyence CA-HX048C/M
- Keyence CA-HX200C/M
- Keyence CA-HX500C/M



P/N PL-CB6

For use with:

- Basler ACE Classic Series
- Basler ACE "L" Series
- Basler ACE "U" Series
- Dalsa Boa Series
- Dalsa Boa 2 Series
- Dalsa Boa Spot Series
- Dalsa Genie, Nano & TS Series
- Dalsa Linea Series
- Datalogic M1xx Series
- Smart Vision LM-45, LM75



P/N PL-CB7

For use with:

- Matrox Iris GTR



P/N PL-CB8

For use with:

- IDS Ensenso X Series



P/N PL-GOPRO

For use with GoPro:

- Blackout Housing
- Camo Housing+Quick Clip
- HERO 4/5/6
- Standard Housing
- Super Suit Housing
- The Frame Housing



All camera brackets sold with mounting hardware as specified in the [AD&D Compatibility Check](#).

* With slight modifications to sensor, light and camera brackets, many other machine vision components can also be mounted and used. Minor drilling of mounting plate may be required. Contact Bock Optronics for further information or assistance.

ADAPTER BRACKETS

P/N **PL-AB1**

Keyence Smart Bracket OP-88310

- For use with HDPL-BALLBASE.



P/N **PL-AB2**

VESA Mount for 75 - 100 mm Mounting Pattern

- For use with PL-BALLBASE, HDPL-BALLBASE.



P/N **PL-AB3**

"The Spencer" Cell Phone / Tablet Adapter Bracket

- For use with PL-BALLBASE.



P/N **PL-AB4**

Keyence XT-024 / XT-060

- For use with HDPL-BALLBASE.

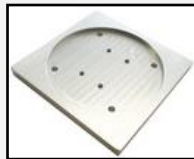

P/N **PL-AB5**

Keyence XR-HT15M /MD and XR-HT40M /MD

- For use with HDPL-BALLBASE.



P/N **PL-AB6**

Keyence LJ-V7020 / V7020K / V7060 / V7060K / V7080

- For use with PL-BALLBASE and HDPL-BALLBASE.



P/N **PL-AB7**

Cognex DS1050 / DS1101 / DS1300 Keyence LJ-V7200 / V7300

- For use with HDPL-BALLBASE.



P/N **PL-AB8**

Keyence LJ-X8020 / X8060 / 8080 / X8200 / X8400 / X8900

- For use with PL-BALLBASE and HDPL-BALLBASE.



P/N **PL-AB9**

LMI Gocator 2130 / 2330 / 2410 / 2420 / 2430

- For use with PL-BALLBASE and HDPL-BALLBASE.



P/N **PL-AB10**

LMI Gocator 2140 / 2340 / 2440 / 3210 / 3504 / 3506

- For use with PL-BALLBASE and HDPL-BALLBASE.



P/N **PL-AB11**

LMI Gocator 2150 / 2170 / 2175 / 2180 / 2350 / 2370 / 2375 / 2380 / 2490

- For use with PL-BALLBASE and HDPL-BALLBASE.



P/N **PL-AB12**

Cognex DS910B / DS925B

Micro-Epsilon 25xx / 26xx / 29xx Series

- For use with PL-BALLBASE and HDPL-BALLBASE.

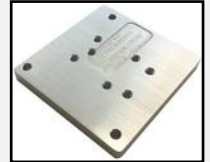

P/N **PL-AB13**

Cognex DSMAX

Micro-Epsilon optoNCDT 1750 / 1750DR / 2300 Series

- For use with PL-BALLBASE and HDPL-BALLBASE.



Mounting Notes:

- All adapter brackets are made from anodized aluminum.
- Adapter brackets are not compatible with Bracket Adaptable (BK) Posts.
- Stainless steel mounting hardware included for appropriate ball base and adapter bracket. See part notes above.

LIGHT BRACKETS

P/N **PL-LB1**

For use with:

- Smart Vision Lights S75 series brick light.



P/N **PL-LB2**

For use with:

- Smart Vision Lights L300 series linear light.



P/N **PL-LB3**

For use with:

- Keyence CA-DRW10X



P/N **PL-LB4**

For use with:

- Keyence CA-DRW5X



P/N **PL-LB5**

For use with:

- Keyence CS-DRM20X
- Keyence CA-DRW20X

* not compatible with bracket adaptable (BK) posts. Mounts to either a PL-BALLBASE or HDPL-BALLBASE.



P/N **PL-LB6**

For use with:

- Keyence CA-DRM5X
- Smart Vision Lights R80 series ring light.



P/N **PL-LB7**

For use with:

- Keyence CA-DRM10X
- Smart Vision Lights R130 series ring light.



P/N **PL-LB8**

For use with:

- Keyence CA-DQP12X



All lighting brackets sold with mounting hardware as specified in the [AD&D Compatibility Check](#).

* With slight modifications to sensor, light and camera brackets, many other machine vision components can also be mounted and used. Minor drilling of mounting plate may be required. Contact Bock Optronics for further information or assistance.

Assembly Example:

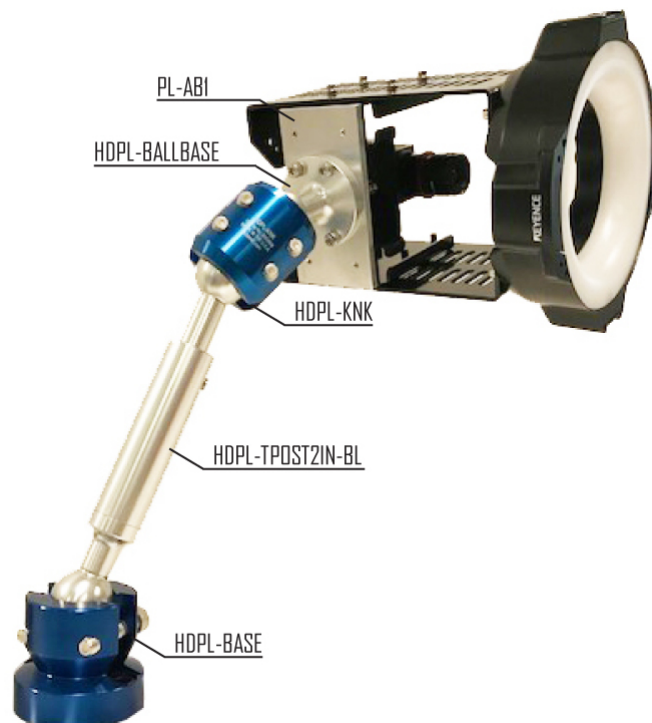

SENSOR & LASER MOUNTING BRACKETS

P/N **PL-SB5MM**

5mm Bracket

For the adaptation of 5mm prox switch, laser or other 5mm product.



P/N **PL-SB8MM**

8mm Bracket

For the adaptation of 8mm prox switch, laser or other 8mm product.



P/N **PL-SB12MM**

12mm Bracket

For the adaptation of 12mm prox switch, laser or other 12mm product.



P/N **PL-SB18MM**

18mm Bracket

For the adaptation of 18mm prox switch, laser or other 18mm product.



P/N **PL-SB30MM**

30mm Bracket

For the adaptation of 30mm prox switch, laser or other 30mm product.



P/N **PL-SB50**

Bracket for use with:

- Banner Q4X series
- IFM OGP280
- IFM O1D300
- IFM O2D202
- IFM O3D302
- IFM O5D100
- IFM O6P202
- IFM O8H216
- Keyence LRZ series



P/N **PL-SBLB**

Large Blank Bracket

A 1.5" (38mm) x 1.75" (44mm) blank that may be machined by the user's specific needs to mount larger devices.



P/N **PL-SBXLB**

Extra Large Blank Bracket

A 4" (101mm) x 4" (101mm) blank that may be machined by the user's specific needs to mount larger devices.



All sensor brackets are made from stainless steel.

** With slight modifications to sensor, light and camera brackets, many other machine vision components can also be mounted and used. Minor drilling of mounting plate may be required. Contact Bock Optonics for further information or assistance.*

Assembly Examples:



CAMERA & SCANNER ENCLOSURES

P/N CEPL-1

Camera Enclosure 1

Compatible with the following Keyence Cameras

- CA-HX048 M/C
- CV/XG-H035 M/C
- CV/XG-H200 M/C
- CV/XG-H500 M/C
- CV/XG-035 M/C
- CV/XG-200 M/C
- LHE16
- LH12
- LH25

Other compact cameras and lenses can be used with the CEPL-1 enclosure, however some modification may be required for camera mounting. Please contact Bock Optronics for more information.

Made from anodized aluminum. Stainless steel mounting hardware for the HDPL-BALLBASE and the Keyence cameras listed above is included.

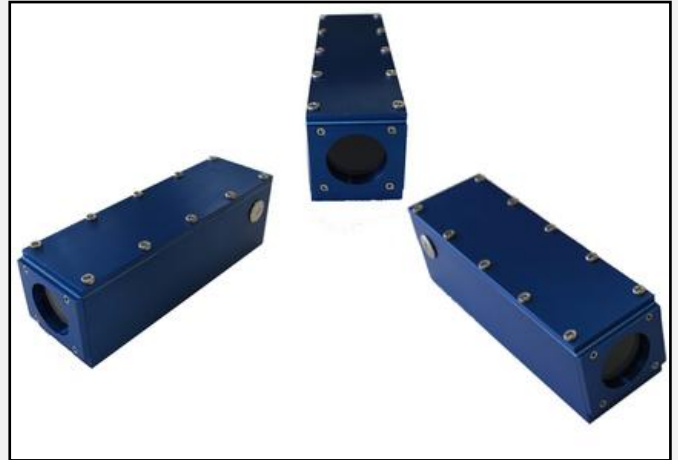

P/N SEPL-1

Scanner Enclosure 1

Compatible with the following Keyence Scanners

- SR750
- SR752
- SR1000
- SR2000

Made from anodized aluminum. Stainless steel mounting hardware for the HDPL-BALLBASE and the Keyence scanners listed above is included.



For more information please contact:

BOCK OPTRONICS INC.

14 Steinway Blvd., Unit 7
Toronto, Ontario M9W 6M6

Tel: (416) 674-2804
sales@bockoptronics.ca
www.bockoptronics.ca