

				UNLESS OTHERWISE SPECIFIED: DIMENSIONS ARE IN INCHES SURFACE FINISH: TOLERANCES: .000= +/- 0.005" .00= +/- 0.010"		FINISH: BURNISHED		Allison Park Group, Inc. (APG) 4055 Alpha Drive Allison Park, PA 15101 USA		DO NOT SCALE DRAWING		REVISION	
				LINEAR:		DEBUR AND BREAK SHARP EDGES		Phone +1 (412) 487-8211 Fax +1 (412) 486-3157		TITLE:		42S-AA (DM500)	
				DRAWN SCHUBERT		SIGNATURE		DATE 6/17/2011		www.apgvision.com		DWG NO.	
				CHK'D						MATERIAL:		316 STAINLESS STEEL	
				APP'VD						WEIGHT:		SCALE:1:5	
				MFG						NOTES:		SHEET 1 OF 1	
				Q.A						A3		42S-AA ASSY DIMS	
				NO. CHANGE		DATE		INIT.					

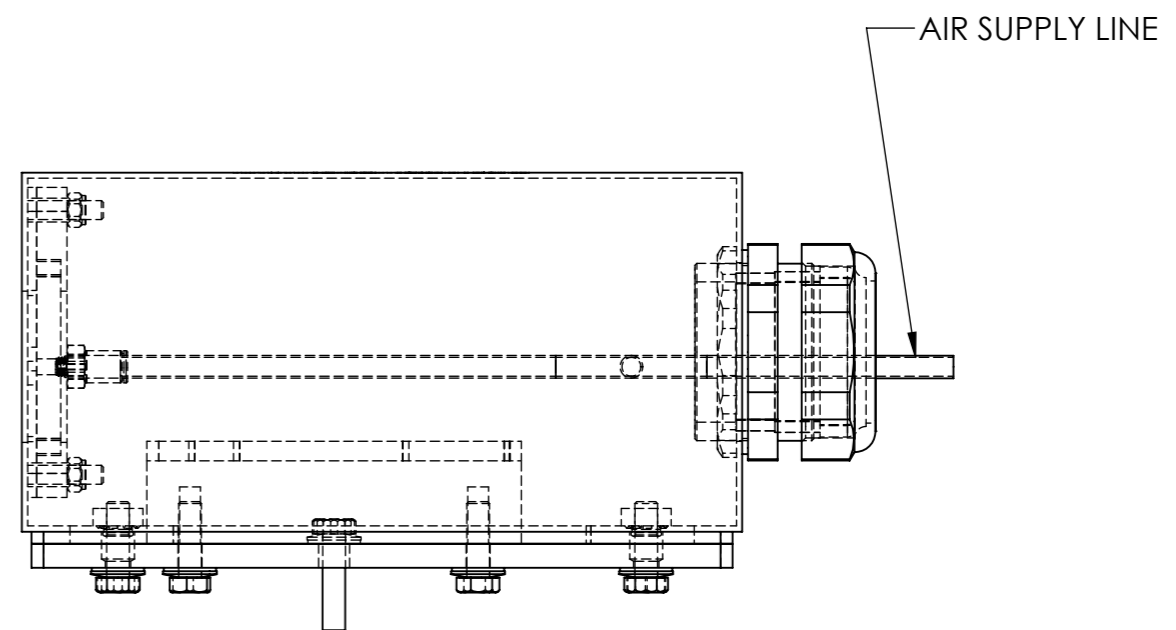

				UNLESS OTHERWISE SPECIFIED: DIMENSIONS ARE IN INCHES SURFACE FINISH: TOLERANCES: .000= +/- 0.005" .00= +/- 0.010"		FINISH: <b>BURNISHED</b> DEBUR AND BREAK SHARP EDGES		Allison Park Group, Inc. (APG) 4055 Alpha Drive Allison Park, PA 15101 USA		DO NOT SCALE DRAWING		REVISION			
				LINEAR:				Phone +1 (412) 487-8211 Fax +1 (412) 486-3157		TITLE:		42S-AD ASSY DIMS			
				DRAWN		NAME		www.apgvision.com		DWG NO.		A3			
				SCHUBERT		SIGNATURE		MATERIAL:		SCALE: 1:2		SHEET 1 OF 1			
				CHK'D		DATE		316 STAINLESS STEEL							
				APPV'D				WEIGHT:							
				MFG											
				Q.A											
				NOTES:											
NO.				CHANGE				DATE				INIT.			

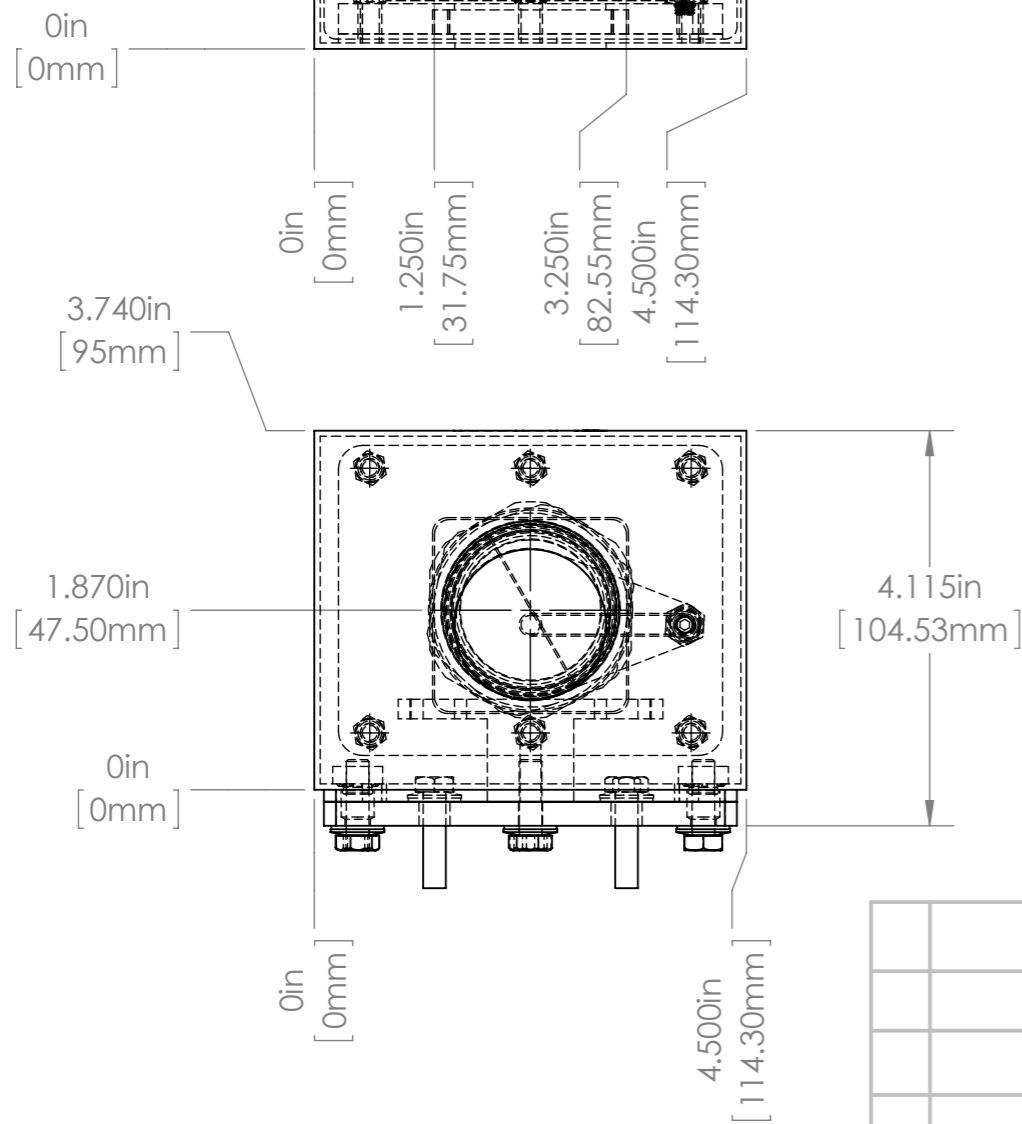
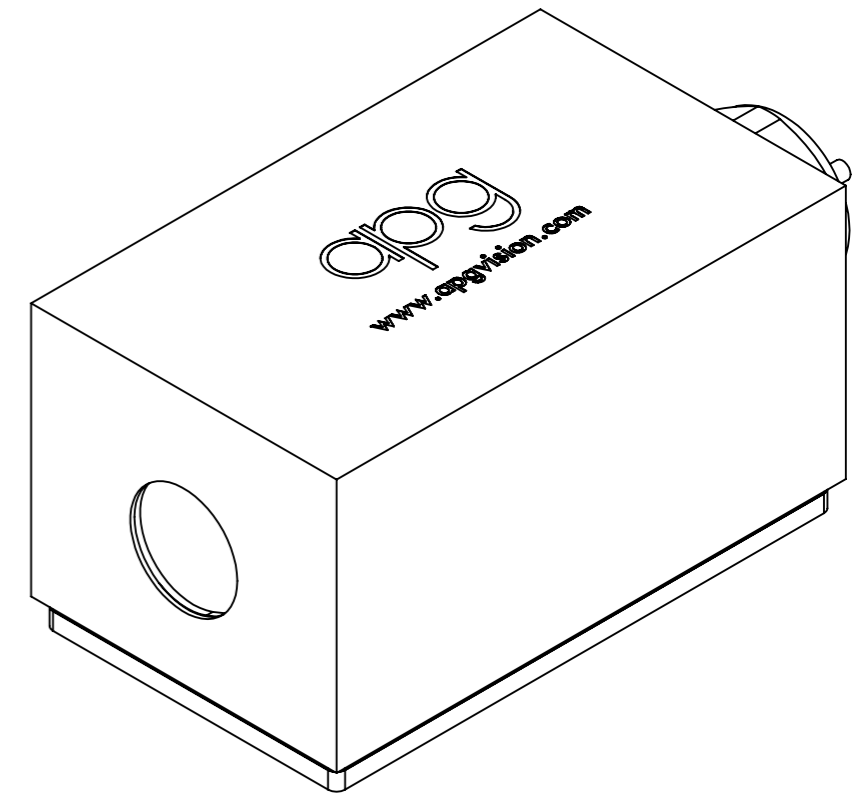
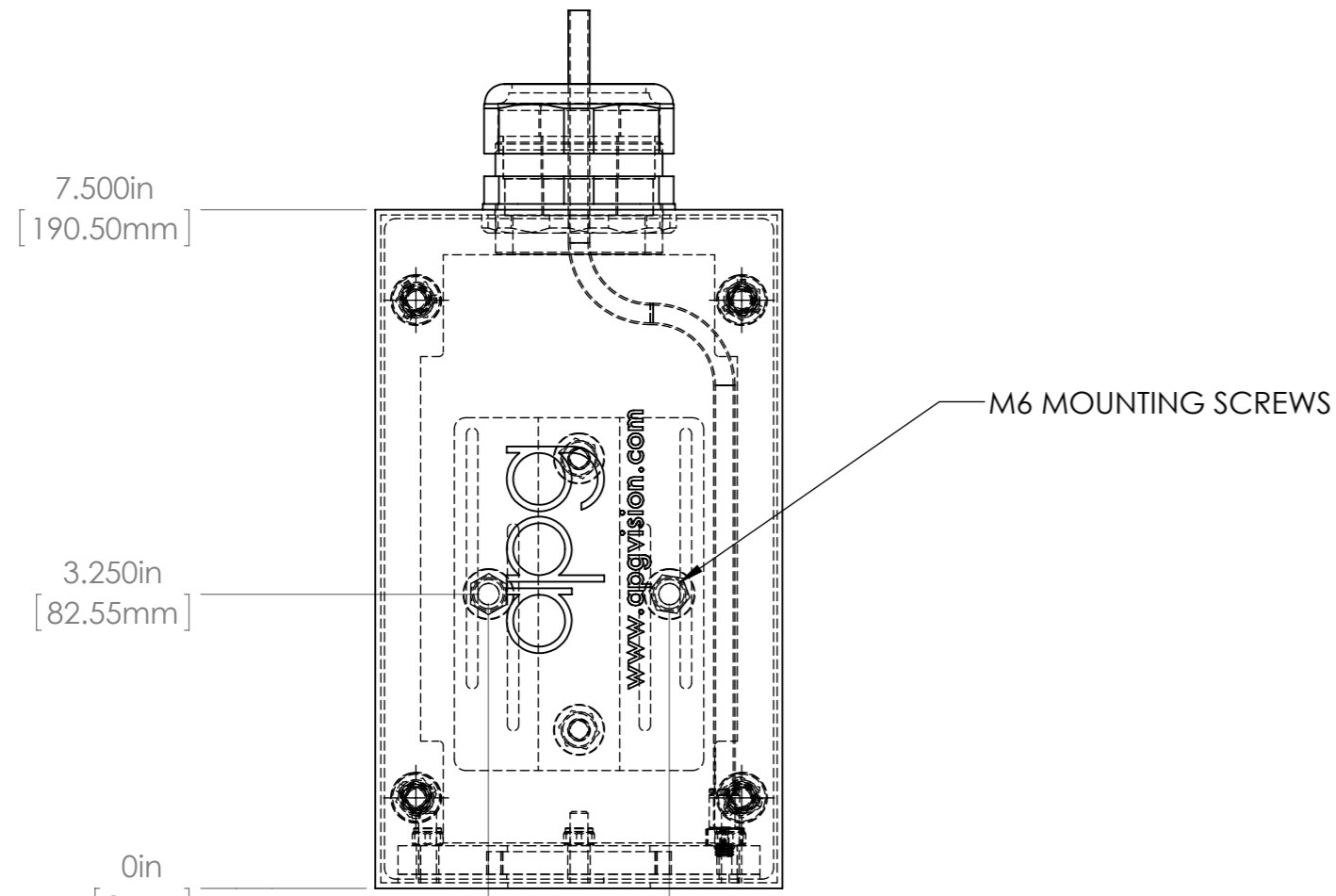
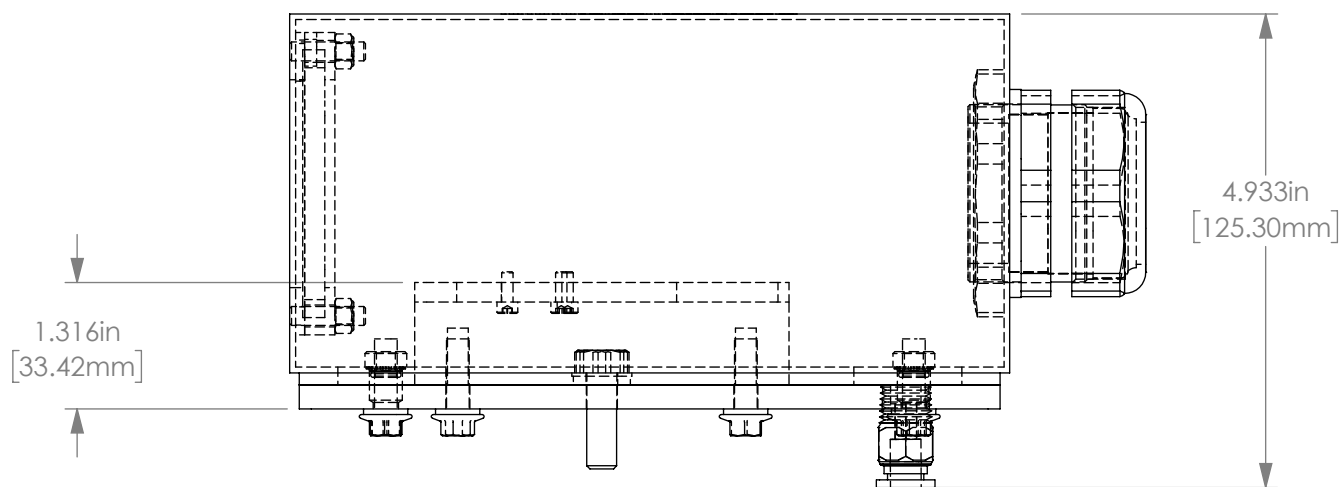
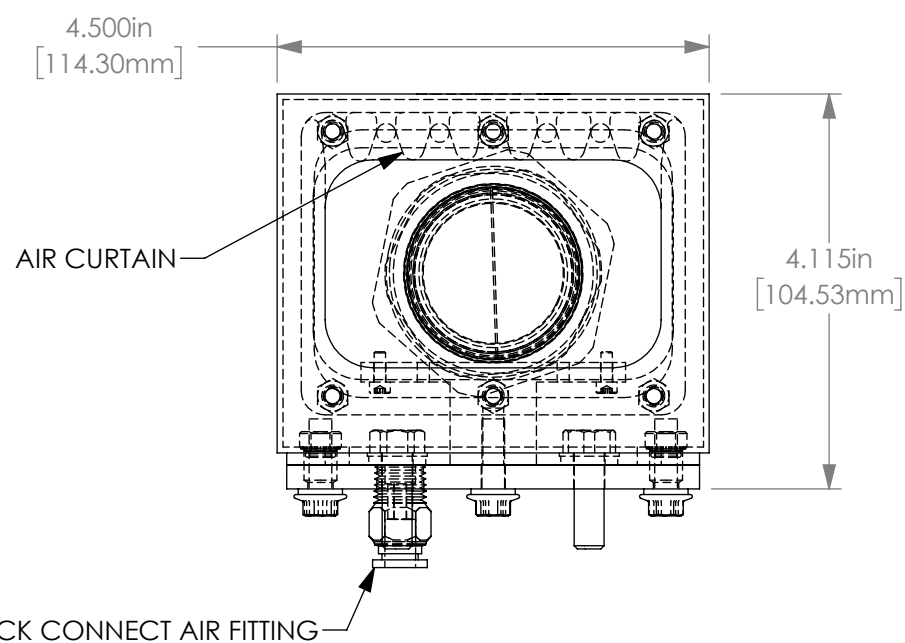
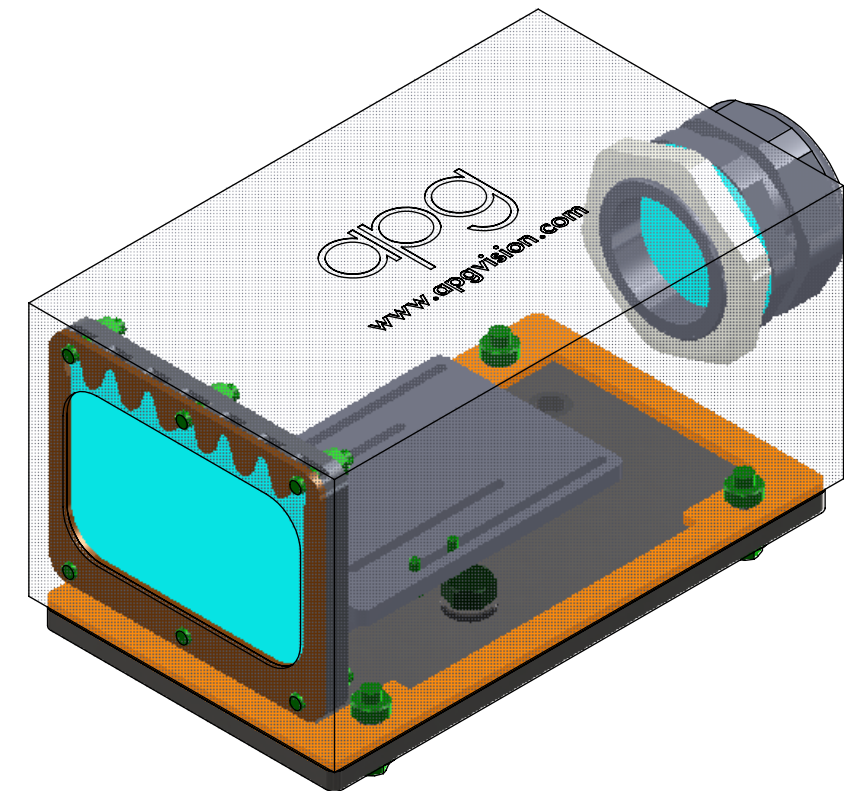
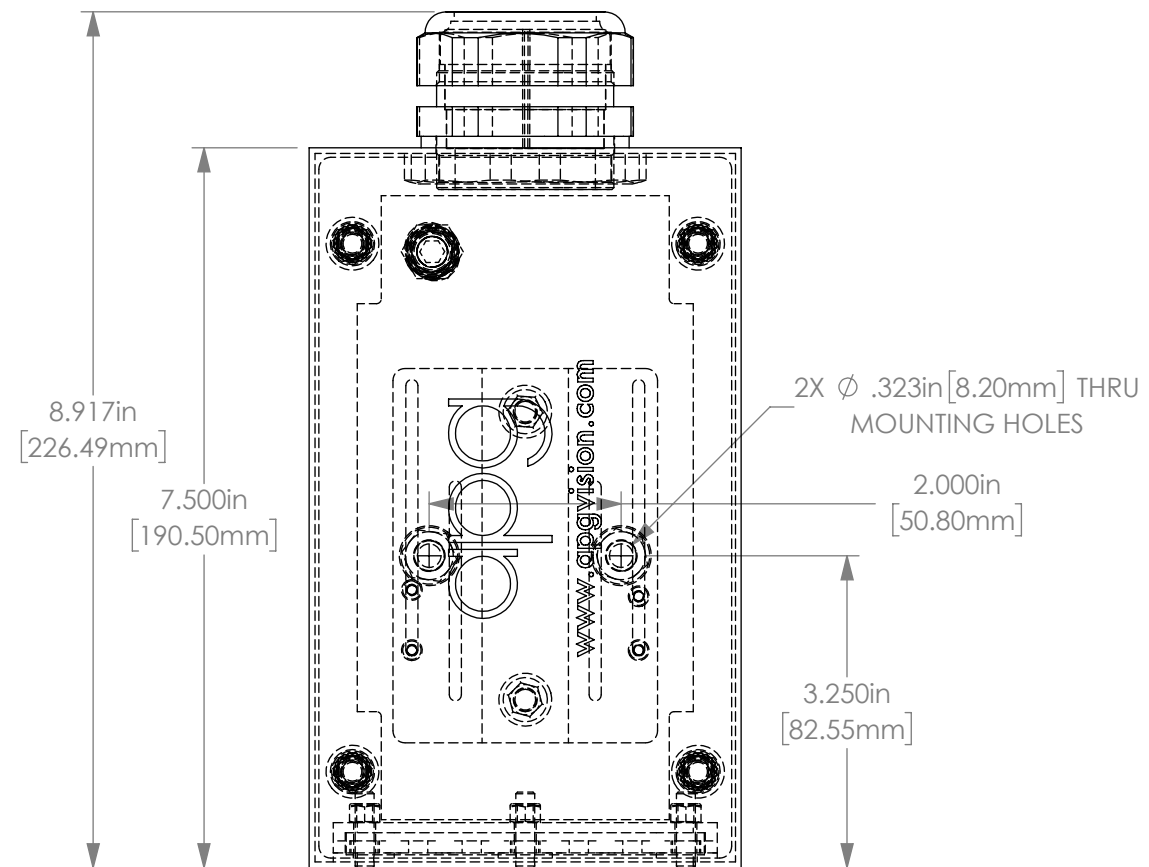

- MATERIALS:**
- 316 STAINLESS STEEL BODY AND BASE
  - SILICONE GASKETS AND SEALS
  - ACRYLIC WINDOW
  - POLYAMIDE CABLE GLAND

TOLERANCES UNLESS OTHERWISE SPECIFIED	
<b>MACHINING</b>	<b>SHEETMETAL</b>
X.X 0.0300	X.X ± 0.0
X.XX 0.0100	X.XX ± 0.020
X.XXX 0.0050	X.XXX NOTED
X.XXXX 0.0025	X.XXXX ANGULAR 0.5°
ANGULAR 0.5°	DEBURR ALL EDGES

ALL WEIGHTS ARE IN POUNDS

THIS PRINT IS THE PROPERTY OF ALLISON PARK GROUP. THE INFORMATION CONTAINED HEREIN IS CONFIDENTIAL. IT IS NOT TRANSFERABLE. IT IS FURNISHED WITH THE CLEAR UNDERSTANDING THAT IT IS NOT TO BE TRACED, REPRODUCED OR USED IN ANY PROCESS OF MANUFACTURING WITHOUT WRITTEN PERMISSION FROM THE OWNER AND IS RETURNABLE UPON DEMAND. ANY INFRINGEMENT UPON THE PATENT RIGHTS SHOWN HEREIN, WHETHER IN PART OR WHOLE, WILL BE PROSECUTED.

AS PART OF OUR POLICY OF CONTINUING DEVELOPMENT, ALLISON PARK GROUP RESERVES THE RIGHT TO ALTER SPECIFICATIONS WITHOUT PRIOR NOTICE.



Allison Park Group, Inc. (APG)  
4055 Alpha Drive  
Allison Park, PA 15101 USA  
Phone +1 (412) 487-8211  
Fax +1 (412) 486-3157

DESCRIPTION: <b>42S-AF (DM500 DM300 GLS ACFP)</b>			
MATERIAL: SEE NOTE AT LEFT		APPROX. WEIGHT	
FINISH:			
DRAWN BY: AW	DATE: 11/28/2018	SCALE: NTS	SHT-SIZE: B
CHECKED BY:	DATE:	PART NUMBER:	REF. NUMBER:
APPROVED BY:	DATE:	<b>42S-AF</b> Sheet 1 of 1	REVISION: <b>A</b>

B

B

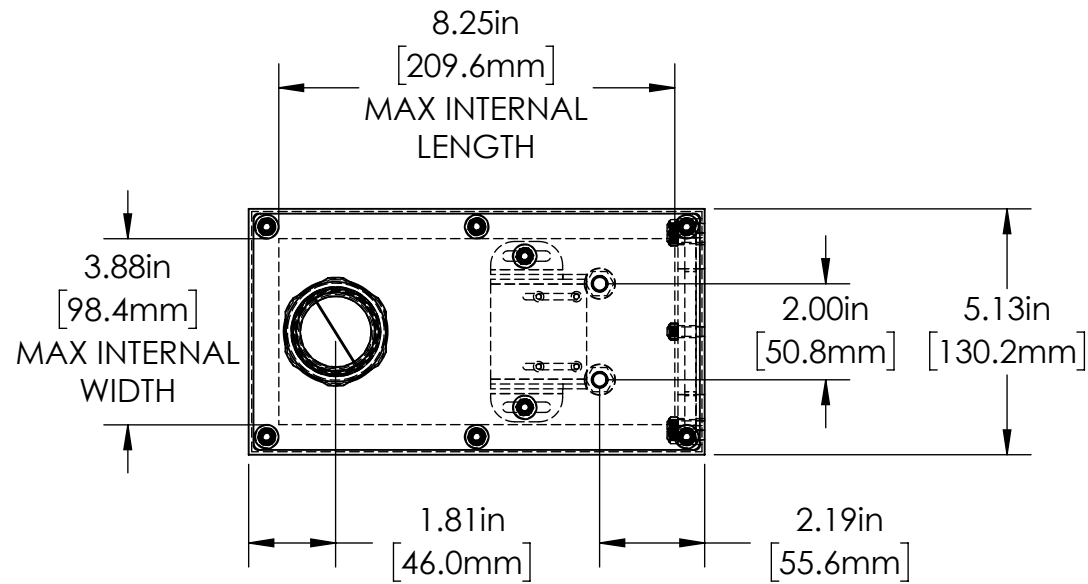
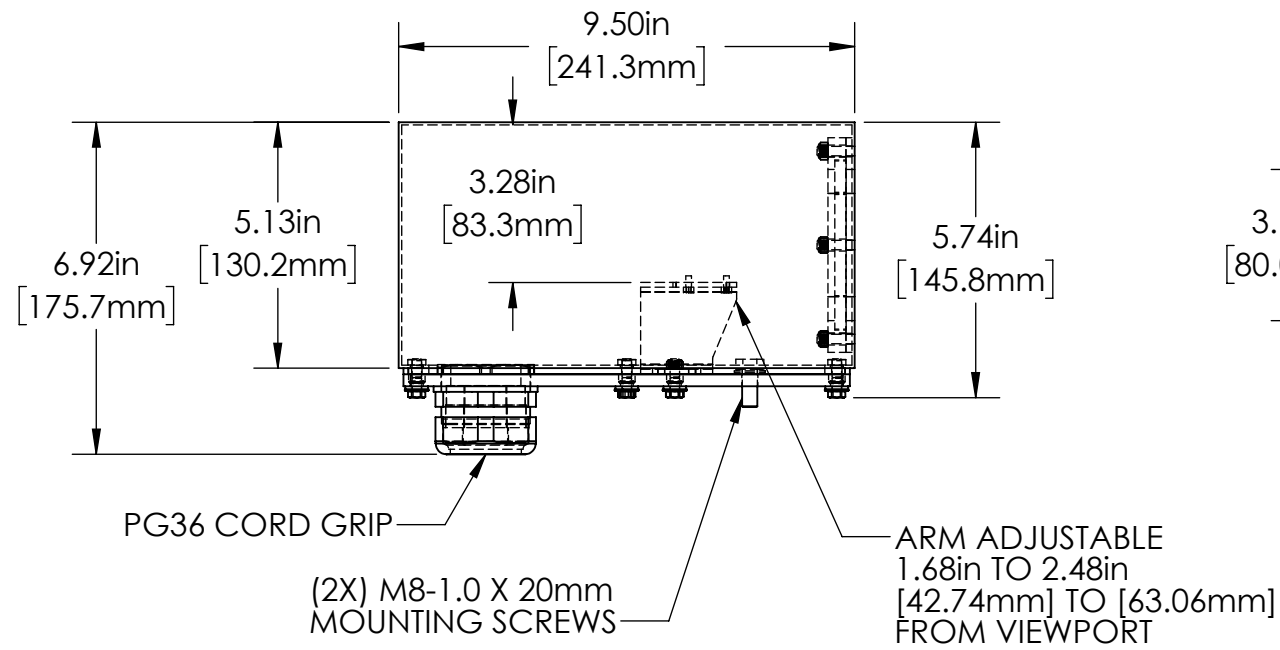

A

A

REVISIONS				
ZONE	REV.	DESCRIPTION	DATE	APPROVED
	A	RELEASED FOR PRODUCTION	7/9/2020	GD

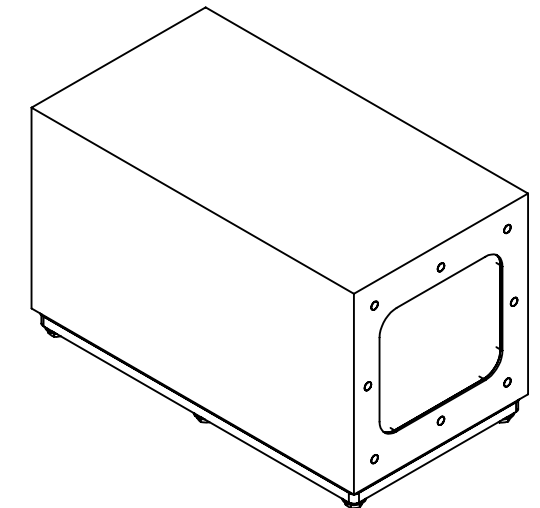

42S SERIES PROPERTIES TABLE		
ENVIRONMENT RATING	IP68*	
	(*RATING MAY CHANGE IF INSTALLER MILLS CABLE GLAND OUTSIDE OF TOLERANCE)	
COMPONENT	MATERIAL	FINISH
BODY	316 SS	BURNISHED
VIEWPORT	ACRYLIC	ABR2
GASKET	40D SILICONE	NONE
ARM/ADAPTOR	5052 ALUMINUM	NONE
HARDWARE	316 SS - EXTERNAL, 18-8 SS - INTERNAL	AS SUPPLIED



For more information please contact:  
**BOCK OPTRONICS INC.**  
 14 Steinway Blvd., Unit 7  
 Toronto, Ontario M9W 6M6  
 Tel: (416) 674-2804  
[sales@bockoptronics.ca](mailto:sales@bockoptronics.ca)  
[www.bockoptronics.ca](http://www.bockoptronics.ca)

TOLERANCES UNLESS OTHERWISE SPECIFIED			
MACHINING		SHEET METAL	
X.X	0.0250"	HOLE TO HOLE (SAME SURFACE)	
X.XX	0.0100"	X.X	0.030"
X.XXX	0.0050"	X.XX	0.010"
X.XXXX	0.0005"	X.XXX	0.005"
ANGULAR	0.5°	X.XXX	0.015"
DEBURR ALL		HOLE TO FOLDED EDGE	
		X.X	0.035"
		X.XX	0.025"
		X.XXX	0.015"
		FOLD TO FOLD	
		X.X	0.045"
		X.XX	0.035"
		X.XXX	0.020"
		ANGULAR 1.0°	

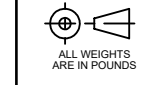

THIS PRINT IS THE PROPERTY OF ALLISON PARK GROUP. THE INFORMATION CONTAINED HEREIN IS CONFIDENTIAL. IT IS NOT TRANSFERABLE. IT IS FURNISHED WITH THE CLEAR UNDERSTANDING THAT IT IS NOT TO BE TRACED, REPRODUCED OR USED IN ANY PROCESS OF MANUFACTURING WITHOUT WRITTEN PERMISSION FROM THE OWNER AND IS RETURNABLE UPON DEMAND. ANY INFRINGEMENT UPON THE PATENT RIGHTS SHOWN HEREIN, WHETHER IN PART OR WHOLE, WILL BE PROSECUTED.  
 AS PART OF OUR POLICY OF CONTINUING DEVELOPMENT, ALLISON PARK GROUP RESERVES THE RIGHT TO ALTER SPECIFICATIONS WITHOUT PRIOR NOTICE.

		Allison Park Group, Inc (APG) 4055 Alpha Drive Allison Park, PA 15101 USA Phone +1 (412) 487-8211 apgvision.com		
DESCRIPTION: <b>EXTENDED ENCLOSURE FOR DM370</b>				
MATERIAL: <b>SEE BOM</b>				
FINISH: <b>SEE BOM</b>				
DRAWN BY: DMM	DATE: 7/9/2020	SCALE: 1:4	SHT-SIZE: B	APPROX. WEIGHT: 7.591
CHECKED BY: GD	DATE: 7/9/2020	PART NUMBER: <b>42S-BC</b>		REVISION: A